

Product Information Sheet

Latch Assembly

CCIND1

- Mark out hole centres as shown and machine slot.
- Once holes have been drilled, position up the Bolt Housing and Face Plate.
- Secure together with the 2 x M4 Bolts supplied, ensure the Bolt mechanism operates signal correctly. ('Green' - Open / 'Red' - Closed)
- Using 2 x No8. x 1" woodscrews secure the bottom two holes of the Bolt Housing to the Door.
- Check for free movement of Bolt and Signal.
- Once satisfied, position the keep to the correct position on the fascia and fix in place with the two No.8 x 5/8" Woodscrews supplied.
- Fit Buffers to top and bottom of the door.

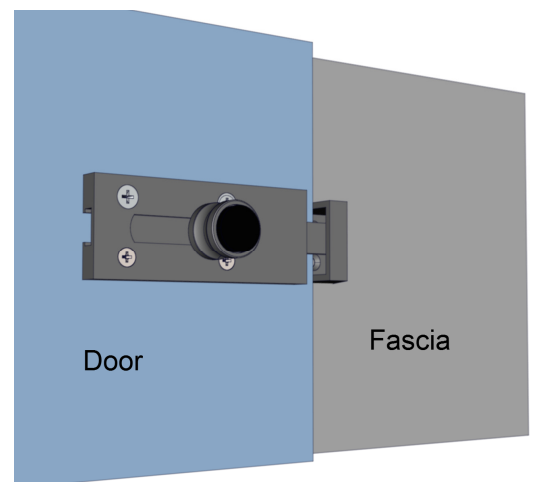
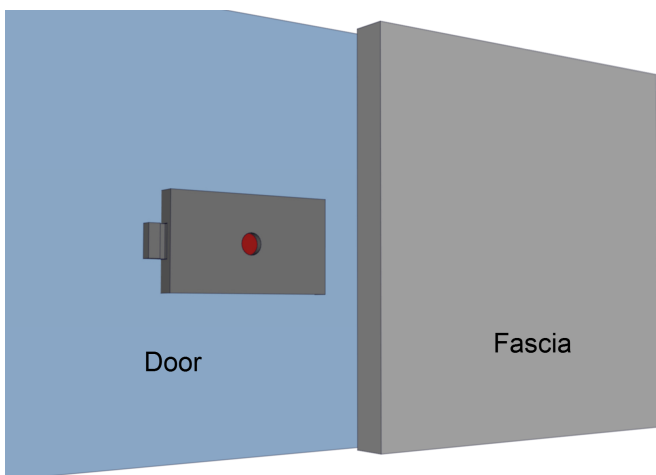
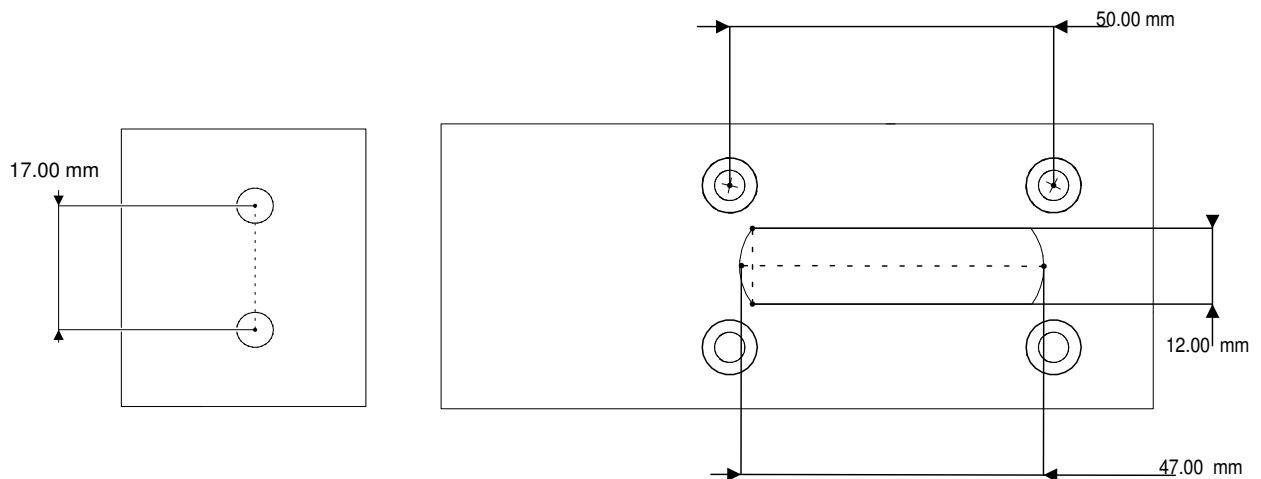

cobtec
cubicle hardware

Unit 15, Dabble Duck Ind. Est.
Shildon
Co. Durham
UK
DL4 2QN