

Product Information Sheet

Coat Hook

CH 7/1 COAT HOOK

- Position Coat Hook in desired place.
- Secure with supplied fixings.

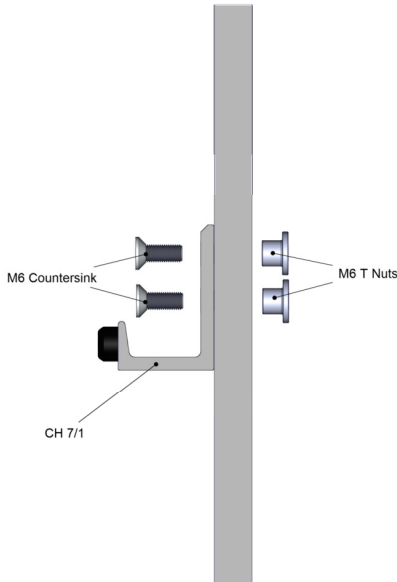

CH 7/1 BOLT THROUGH

Drill Panel $\varnothing 9.5\text{mm}$

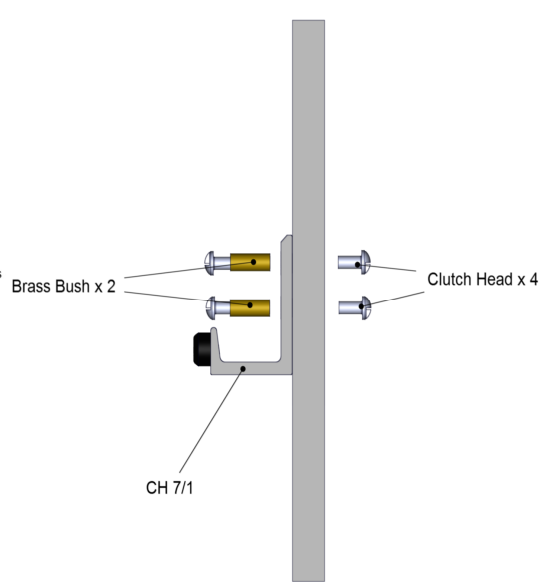

CH 7/1 COMP

Drill Panel $\varnothing 6.5\text{mm}$

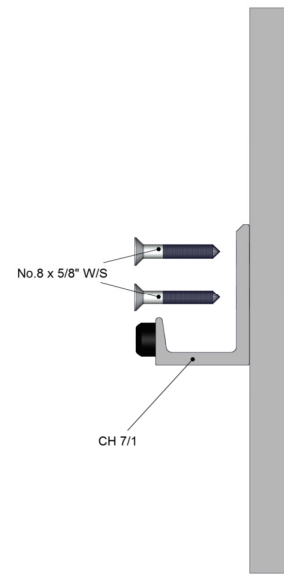

CH 7/1 C/W

Can be Pre-drilled with pilot $\varnothing 3.5\text{mm}$

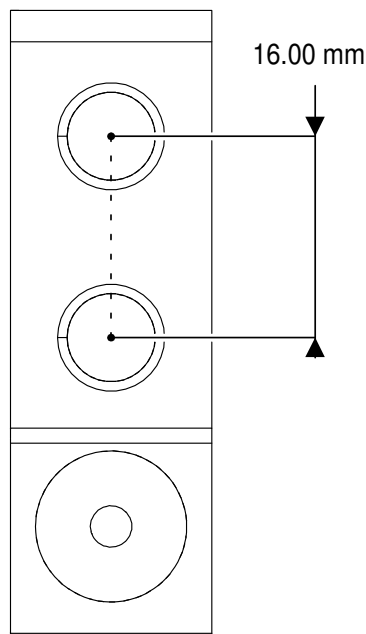

cobtec
cubicle hardware

Unit 15, Dabble Duck Ind. Est.
Shildon
Co. Durham
UK
DL4 2QN