

# Product Information Sheet

## Latch Assembly

### FPR 1/1 COMPLETE

- Mark out hole centres as shown and machine slot.
- Once holes have been drilled, position up the Bolt Housing and Face Plate.
- Secure together with the M4 Bolts supplied, ensure the Bolt mechanism operates signal correctly. ('Green' - Open / 'Red' - Closed)
- Using the two No.8 x 1" Woodscrews secure the bottom two holes of the Bolt Housing to the Door.
- Check for free movement of Bolt and Signal.
- Once satisfied, position the keep to the correct position on the fascia and fix in place with the two No.8 x 5/8" Woodscrews supplied.
- Fit Buffers to top and bottom of the door.

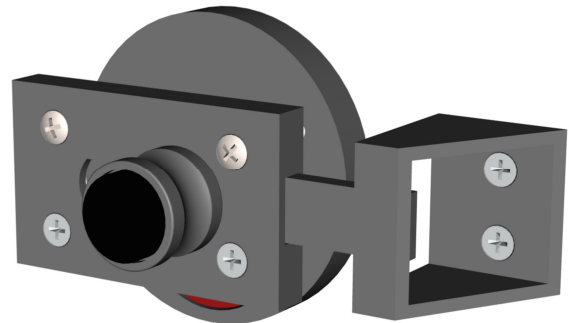
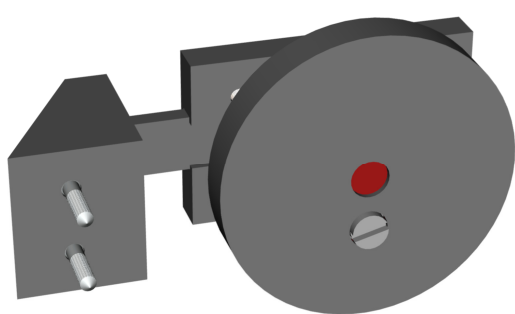
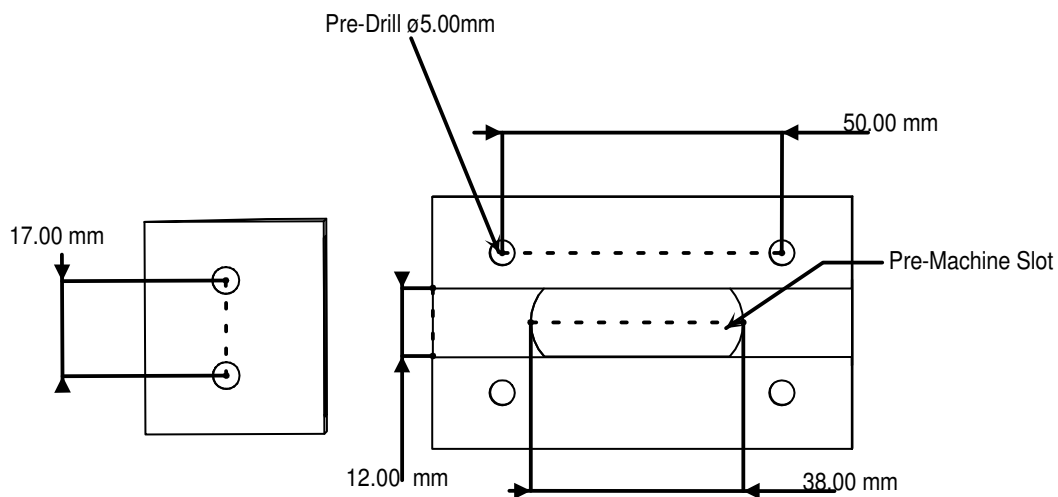

**cobtec**  
cubicle hardware

Unit 15, Dabble Duck Ind. Est.  
Shildon  
Co. Durham  
UK  
DL4 2QN