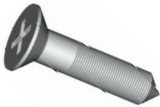

Product Information Sheet

Brackets

WM 3/3

- To fix brackets to the wall refer to Information sheet ' Guide to fitting Brackets to Wall'
- Secure partition to brackets using fixings provided.

| | | |
|--|----------------------------------|-----------------|
|  | WOODSCREWS | CODE |
| | Woodscrews | WM 3/3 COMP W/S |
| | Pilot $\varnothing 3.5\text{mm}$ | |
|  | ANTI-VANDAL DRILL THROUGH | CODE |
| | Anti-vandal | WM 3/3 COMP AV |
| | Drill Through | |
| | $\varnothing 6.00\text{mm}$ | |

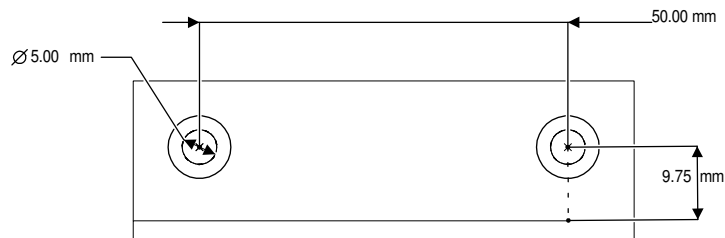
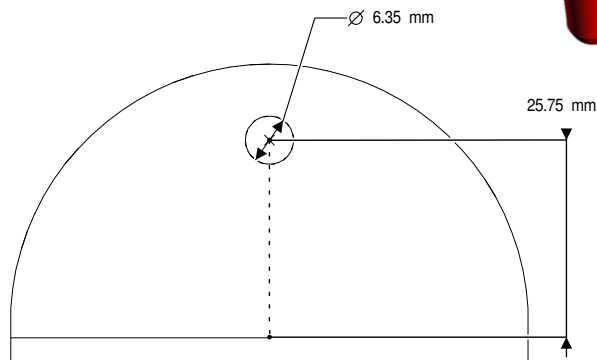
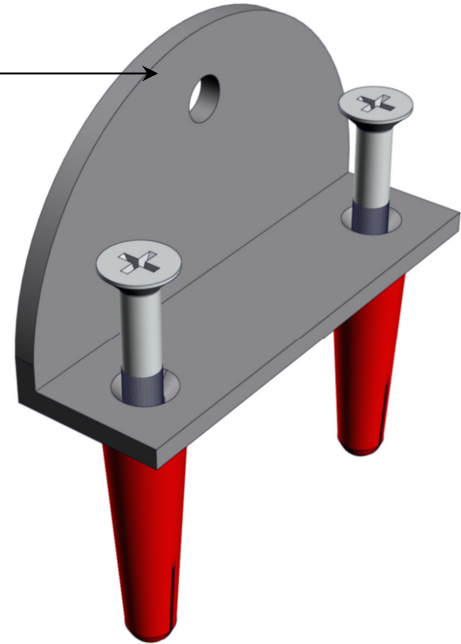

cobtec
cubicle hardware

Unit 15, Dabble Duck Ind. Est.
Shildon
Co. Durham
UK
DL4 2QN